

# P500 Therapy Surface Quick Tips

# CPR

The CPR control is located on front of control unit at the upper left-hand corner.

- When CPR is pressed, the system hyper-inflates to supply a firm surface for CPR.
- CRP mode will remain active for 60 minutes.
  - Two minutes before CPR mode times out, an alarm will alert you that the surface will be returning to normal mode. For additional time, press CPR control.
  - To end CPR mode before 60 minutes, press surface mode control until indicator illuminates and light bar is green.



*Note: The CPR control does not control the bed position. Bed will have to be placed into position for separately using bed controls.*

# New Patient Setup – Entering Patient Weight

Enter the weight as follows:

- Press **lb/kg** control to change weight dimension.
- Press the plus (+) control.
- Press plus (+) or minus (-) control to change weight shown on the display.



*Note: If, after five minutes, patient weight has not been entered, an audible alarm will sound and “Enter Patient Weight” will flash. This is to let you know the surface pressures may not be correct for patient.*

# Control Panel

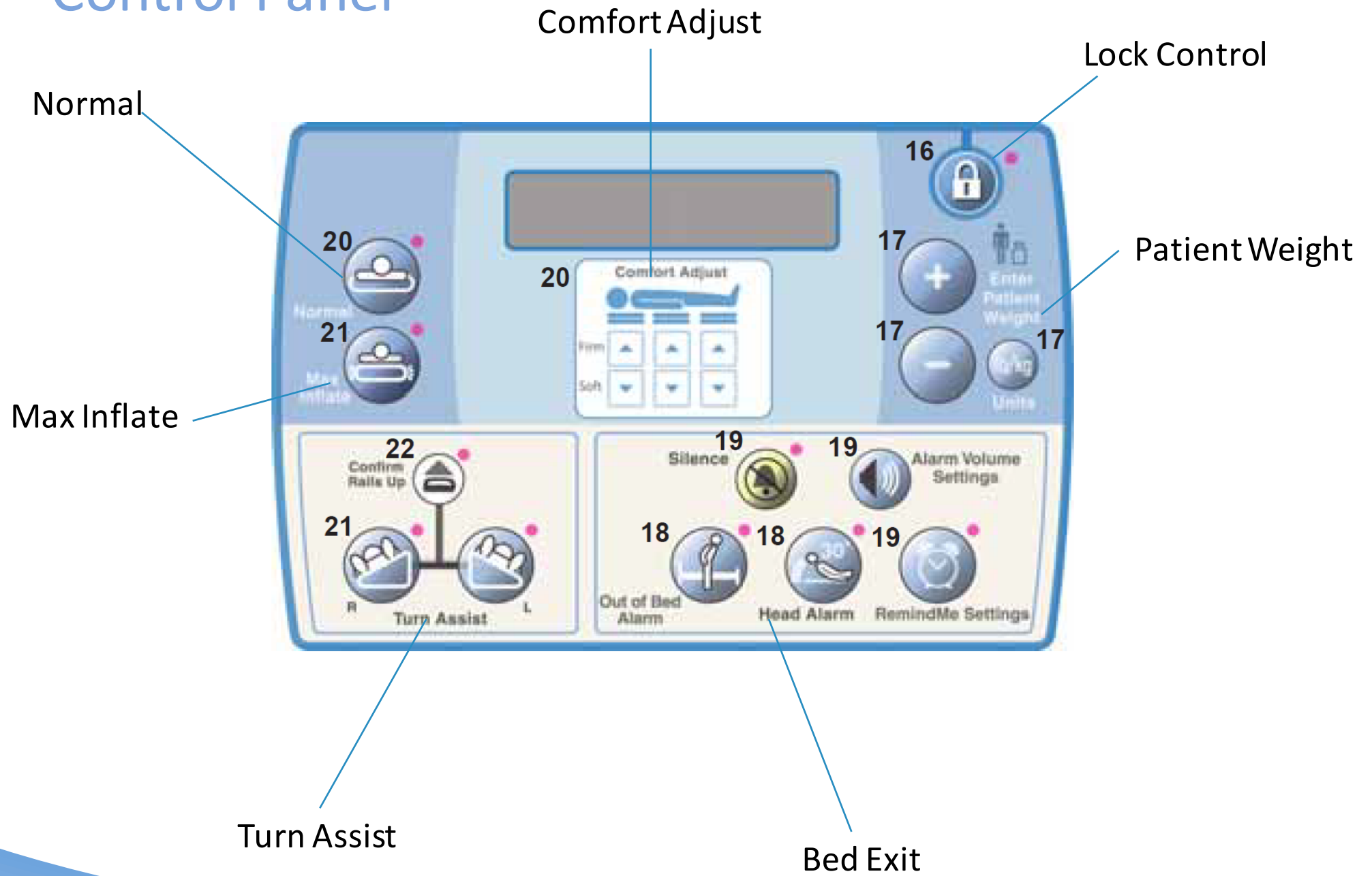

# Lockouts

- **Lock:** Press and hold “lock” control until indicator light illuminates.

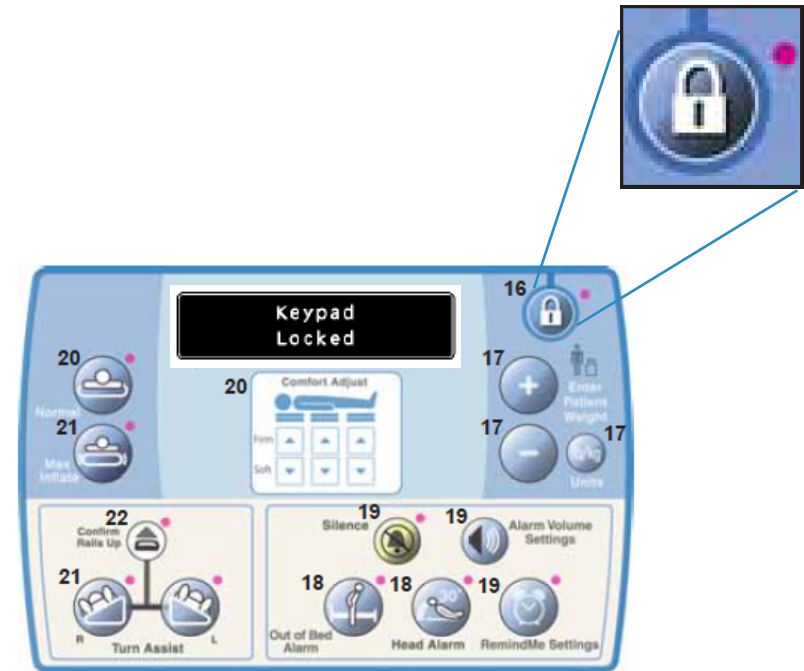

- **Unlock:** Press and hold “lock” control until indicator light turns off.

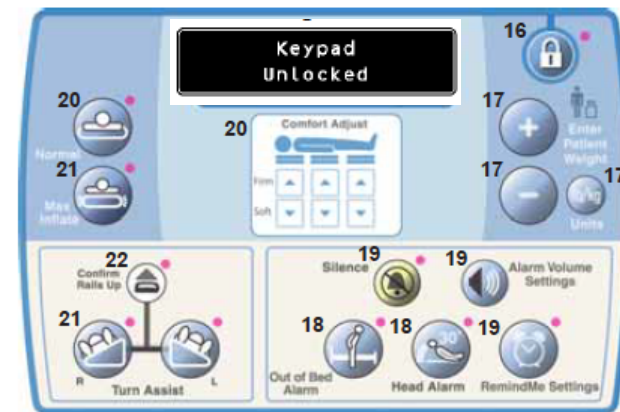

*Note: The lockout does not lockout CPR.*

# Max Inflate

To help make it easier to reposition in bed, Max Inflate can be used.

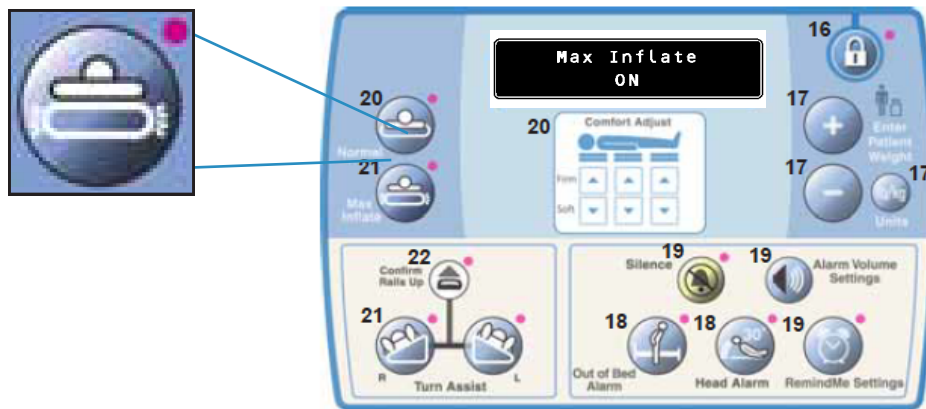

- **To Activate:** Press the “Max Inflate” control until indicator illuminates.

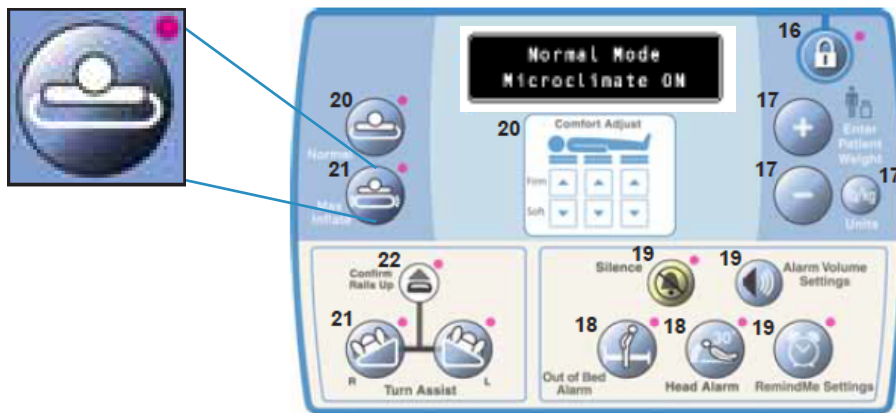

- **To Deactivate:** Press “Normal” control until indicator illuminates.

*Note: After 30 minutes of Max Inflate, surface returns to Normal mode.*

# Control Panel – Turn Assist

## To Activate:

1. Ensure occupant is centered on surface.
2. Ensure head of bed is below 30° and head of bed alarm is off.
3. Ensure bed siderails are raised and locked and press “Confirm Rails Up” control until indicator illuminates.
5. Press and hold “Turn Assist R or L” control until indicator illuminates.

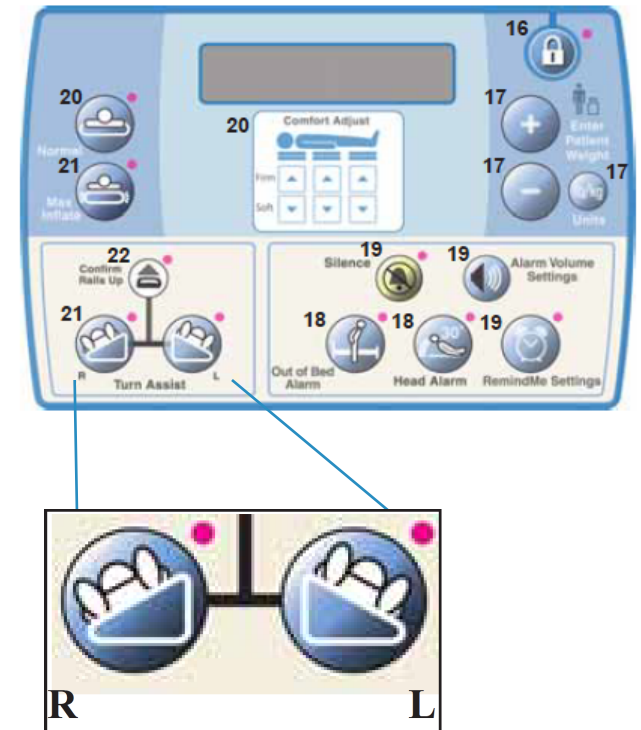

*Note: Before putting surface into Turn Assist mode, make sure bed siderails are raised and locked.*

# Comfort Adjust

Comfort adjust can be used to change air pressure from softer to harder in head, seat and foot sections.

- There are five pressure levels: softer, soft, normal, firm, and firmer. The default pressure level is normal.
  - **To increase or decrease pressure:** Press “up or down arrows” until you reach the applicable pressure level.

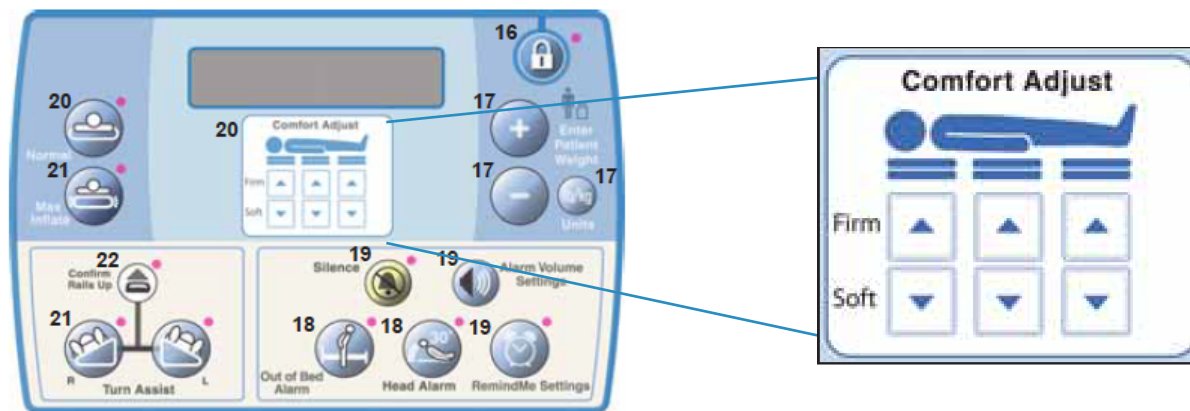



# Sleep Mode

Sleep Mode temporarily turns off air system to help patients sensitive to surface movement to sleep.

- **To Active:** Press and hold “Turn Assist R and L” controls simultaneously until indicators illuminate.
  - Sleep mode remains active for eight hours; system will automatically return to normal mode.
- **To Deactivate:** Press and hold any surface mode control until indicators illuminate.

# Out Of Bed Alarm

Out of bed alarm monitors patient weight and will alert when patient weight is not detected.

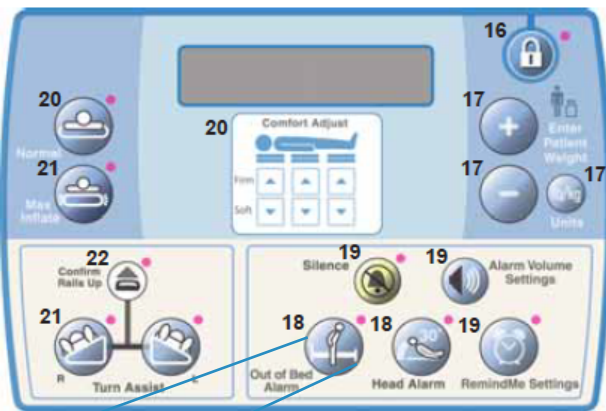

- **To Activate:** Press and hold the “Out of Bed” control until indicator light illuminates.
- **To Deactivate:** Press and hold the “Out of Bed” control until indicator light turns off.



*Note: For bed frames with a Bed Exit Alarm System, recommend using surface Out of Bed Alarm instead of frame system.*

# Head of Bed Alarm

To help maintain a head elevation of greater than 30°, an alert can be set to sound if head of bed drops below 30°.

- **To Activate:**
  1. Ensure bed is not in Trendelenburg or Reverse Trendelenburg.
  2. Raise head of bed to at least 30°.
  3. Press and hold “Head Alarm” control until indicator illuminates.
- **To Deactivate:** Press and hold “Head Alarm” control until indicator turns off.

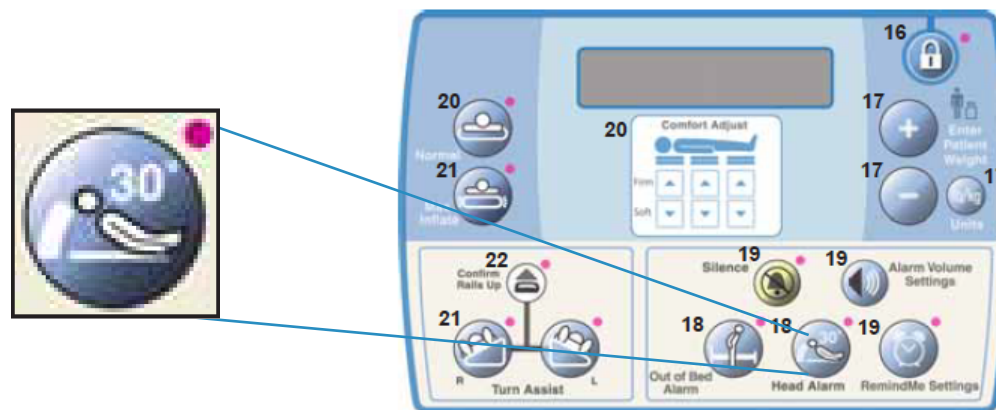

# Silence

When surface is alarming, the Silence feature can be used to silence the alarm for up to 30 minutes.

- Press and hold “Silence” control until indicator light illuminates.
- After 30 minutes, if problem has not been corrected, the system will begin alarming.

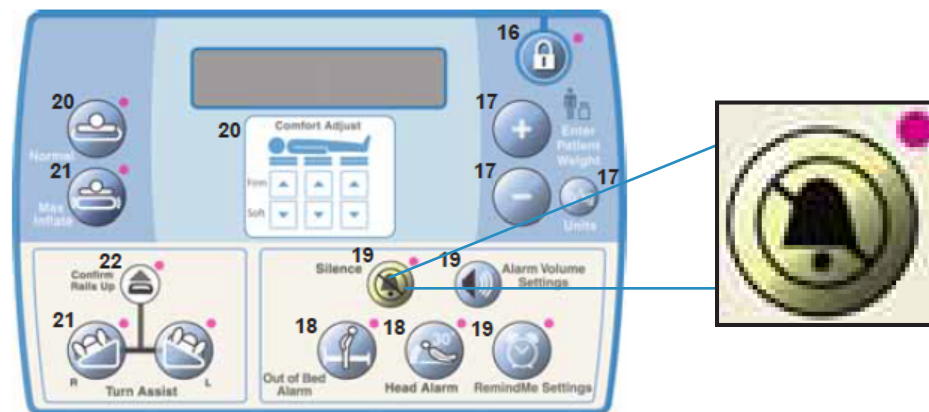

*Note: If silence was pressed due to an Out of Bed alarm and patient returns to surface, the out of bed will automatically re-arm.*